



# Pioneer2.0\_C

## Over Counter Electric Dispenser

Specification Guide

Pioneer2.0\_C



Short Edition



Tall Edition

## Features

### Key Feature 1

Separately refrigeration deck, fan & agitator  
Modular

### Key Feature 2

Large LED illuminated graphic for maximum  
branding impact

### Key Feature 3

New water level sensor design to increase  
the component's reliability

### Key Feature 4

Small footprint and no side louvers, no  
constraints on setting equipment side by side

### Key Feature 5

External removable condenser filter

### Key Feature 6

With rat guard design





# Pioneer2.0\_C

## Over Counter Electric Dispenser

Specification Guide

### Technical Specification

<b>Model</b>	Pioneer 2.0_C
<b>Electrical</b>	230V 50Hz
<b>Refrigerant</b>	R290
<b>Ice Bank Size</b>	16.5lbs. / 7.5Kg
<b>Compressor Size</b>	1/4HP+
<b>Operating Conditions</b>	50°F to 90°F (10° C to 32.2°C)
<b>Dispenser Dimensions</b>	Short : 14.7'W x 26.6'D x 27.8'H 375 mm*675 mm*705mm Tall : 14.7' W x 26.6'D x 31.9'H 375 mm*675 mm*810mm
<b>Recommended Clearance</b>	Top: 18.0' (450mm) Back: 6.0' (152 mm) and Sides: 6.0' (152 mm)
<b>Weight</b>	Operating: SHORT-201 lbs.(91kg); TALL-214 lbs(97 kg) Shipping: SHORT-154 lbs.(70kg); TALL-168 lbs(76 kg)
<b>Continuous Draw capacity</b>	
<b>@2drinks per minutes@12oz</b>	
<b>@105°F(40.6°C)65%RH</b>	N/A
<b>@90°F(32.2°C)65%RH</b>	60 drinks
<b>@75°F(24°C)75%RH</b>	110 drinks
<b>Water Bath Size</b>	36L
<b>Water Connection</b>	3/8" barb fitting on dispenser
<b>Water Supply Requirements</b>	Water pressure: 20-65PSI (0.14Mpa-0.45Mpa) NCB circuit pressure >40PSI (0.28Mpa) <i>For water pressure exceeding the optimum supply specification, flow control set at 50psi is recommended</i>
<b>Flow Rate</b>	Beverage pour rate 1.5-3oz/sec
<b>Agency Listing</b>	 

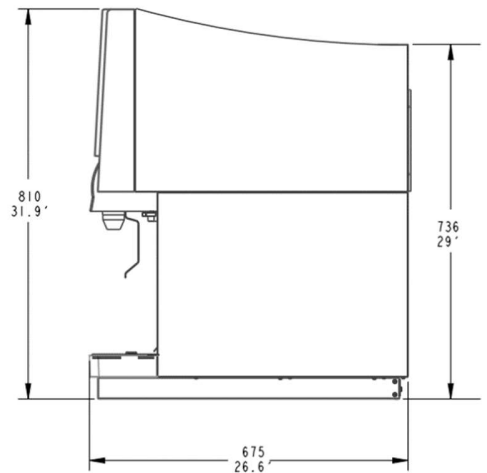
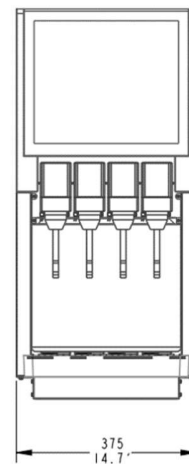
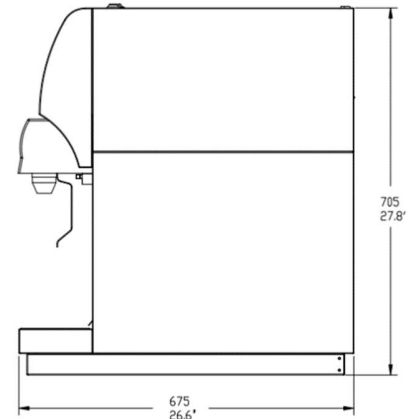
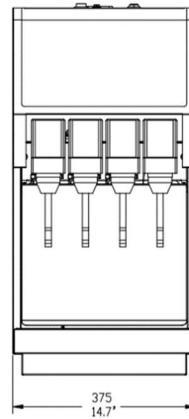

Model Number	Description

Accessories Number	Description

To learn more and see **Pioneer2.0\_C** in action, visit [cornelius.com](http://cornelius.com)  
To contact us directly, go to [cornelius.com/contact-us](http://cornelius.com/contact-us)